

65

H71-350

5-112

C172-131
J. Cunningham

J Stefle

C234-132

J. Moore

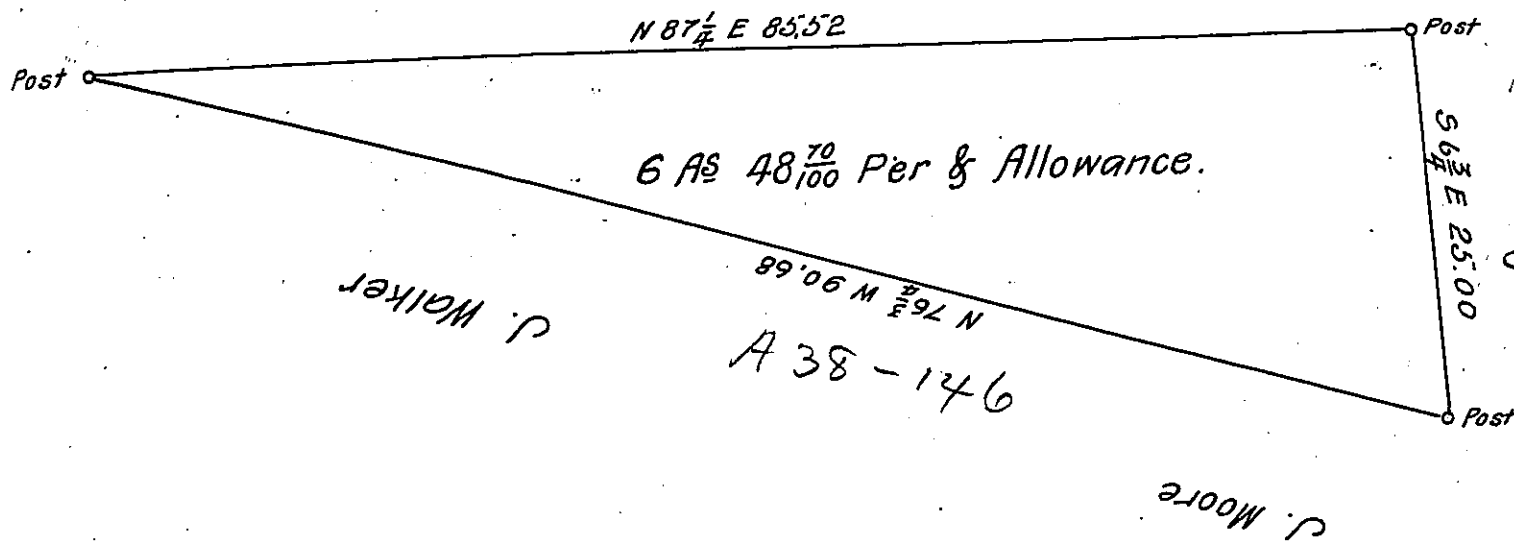

Draught of a Piece of Land. Situated partly in Mifflin and partly in Baldwin Township Allegheny County Penna. Surveyed November 19th 1870. in pursuance of a Warrant granted to Charles S. Fetterman dated 23rd day of May A. D. 1870. Containing 6 Acres 48 ⁷⁰/₁₀₀ Per and Allowance of six per cent for Road &c

R. L. McCully C. S.

To Jacob M. Campbell
Surveyor General

IN TESTIMONY that the above is a copy of the original remaining on file in the Department of Internal Affairs of Pennsylvania, made conformably to an Act of Assembly approved the 16th day of February, 1833, I have hereunto set my Hand and caused the Seal of said Department to be affixed at Harrisburg, this twenty first day of December 1904.

Loae R. Brown
Secretary of Internal Affairs.